

Wall and ceiling panels (MDF)

This information sheet contains important suggestions with respect to the materials and their treatment. Read it carefully and preserve it with care.

Features

**Use and function:**

High-quality panel for wall and ceiling systems.

Dimensions & weight:

600mm x 2400mm, 8kg

Components	Material	Weight proportion
Profiles	Wrapped MDF (see PD23006)	81%
Felt board	Felt made from recycled plastic	18%
Fixation	Galvanised steel staples	1%

**Tolerances:**

PEDROSS N13001

**Moisture content at delivery:**

< 7 %

**Formaldehyd emission:**

according to ISO 16000, meets requirement of RAL-ZU 38 (EPH Nr.251472/1/B)

**Resistance to fungal and insect attack:**

DIN EN 335-3:1995; class 2

Storage conditions



Store the panels upright or on a flat surface



Protect from exposure to chemical substances



Protect from moisture



Ideal storage temperature 18°C
min. 10°C - max. 40°C



Protection from sunlight



Storage at humidity of 55 - 70%

Consequential damage due to improper storage

- Colour changes on the surface
- Damage to the lacquer coating
- Crack formation
- Curvature, twisting
- Dimensional differences due to shrinkage and swelling
- Delamination of the decor material

Wall and ceiling panels (MDF)

This information sheet contains important suggestions with respect to the materials and their treatment. Read it carefully and preserve it with care.

Mounting suggestion

a) Fixing the individual panels to the masonry (without superstructure) from the front with black screws between the profiles on the black felt. Round-head screws 4.0x40 mm incl. matching dowels. We recommend at least 15 screws per panel.

b) Drawn structure corresponds to the acoustic test, rated sound absorption coefficient: $\alpha_w = 0.85$, sound absorber class B. Mounting of solid wood panels on masonry, 60mm high, 50mm thick, clear distance 600mm, number, length and type of screws and dowels depends on the surface and is to be determined individually. Between them insulation, 50 mm thick, length-related flow resistance $AF_r \geq 6 \text{ kPa}\cdot\text{s}/\text{m}^2$ according to ÖNORM EN ISO 29053. Hollow space (50 mm) between wall and insulation, ensures even greater sound absorption. Mounting of the skirting board elements, screwed from the front using black screws between the skirting boards on the black felt, round-head screws 4.0x40mm, we recommend at least 15 screws per element.

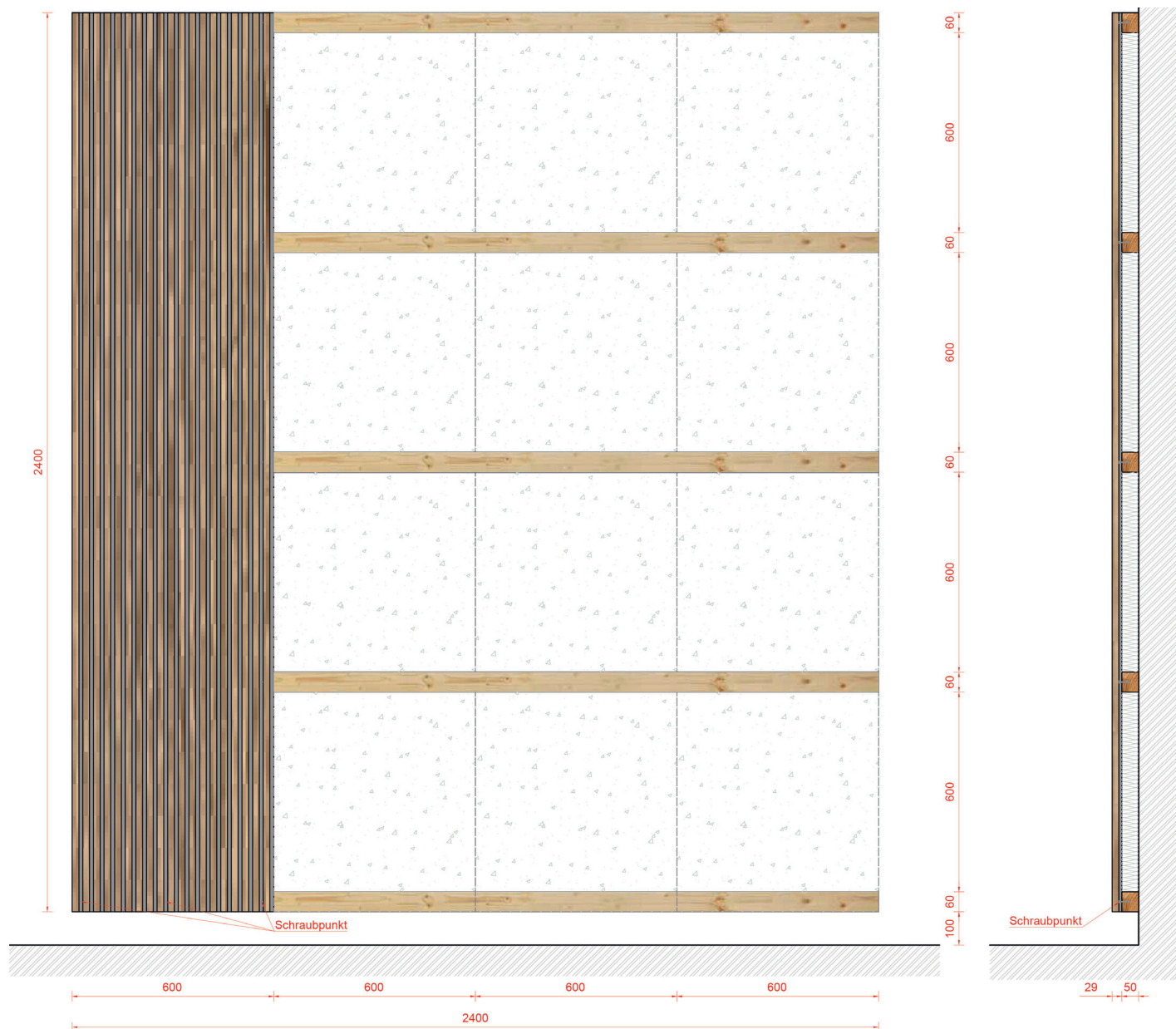

Example image for panel 600 x 2700 mm

This information sheet contains important suggestions with respect to the materials and their treatment. Read it carefully and preserve it with care.

Sound absorption coefficient with different mounting

Sound absorption coefficient in accordance with EN-ISO 354-2003, measurement of sound absorption in a reverberation chamber.

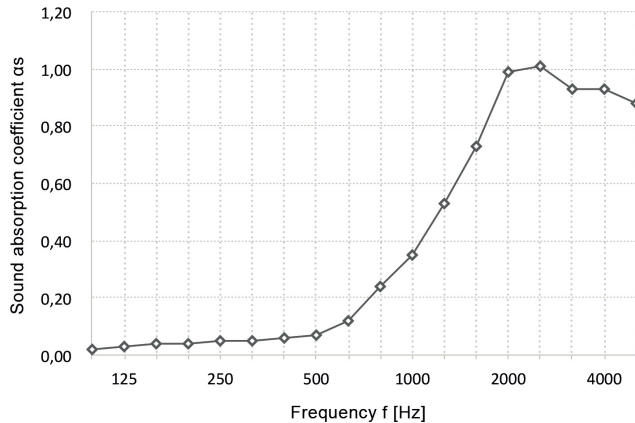

Evaluated sound absorption coefficient: $\alpha_w = 0.20$ (H)
Sound absorber class: E

Installation:
Panel mounted directly on the wall.

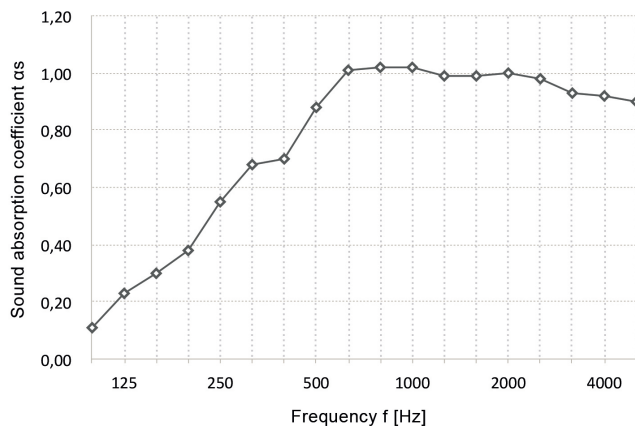

Evaluated sound absorption coefficient: $\alpha_w = 0.85$
Sound absorber class: B

Installation:
Panel with insulation behind.

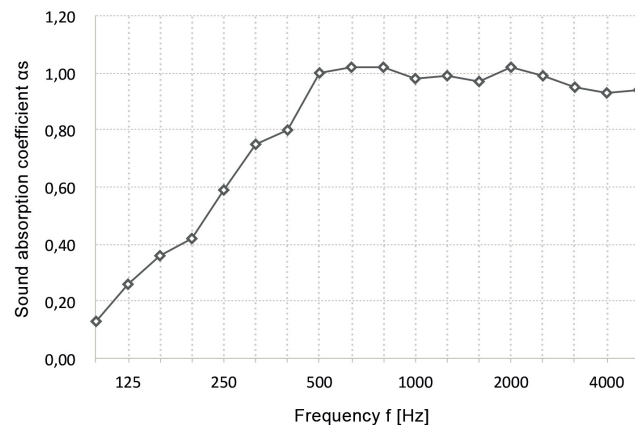

Evaluated sound absorption coefficient: $\alpha_w = 0.90$
Sound absorber class: A

Installation:
Panel with insulation behind.
Hollow space between wall and insulation.



Wall and ceiling panels (MDF)

This information sheet contains important suggestions with respect to the materials and their treatment. Read it carefully and preserve it with care.

Background



dry



free from dust



straight



resistant

Care and disposal



Use soft towels or cloths and non-aggressive detergents for regular cleaning



Avoid any rubbing or detergents that require rubbing



Dispose an environmentally friendly way after dismantling or at the end of the utilization



Avoid the accumulation of water or liquid products

Packaging

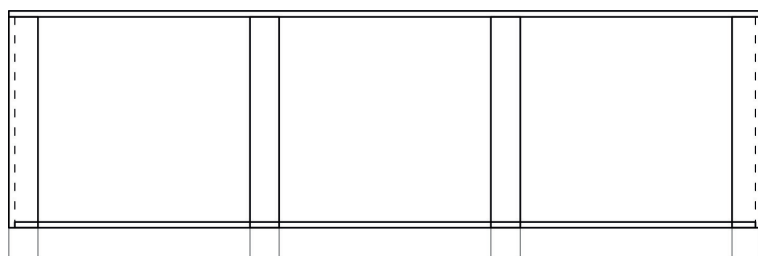

1200

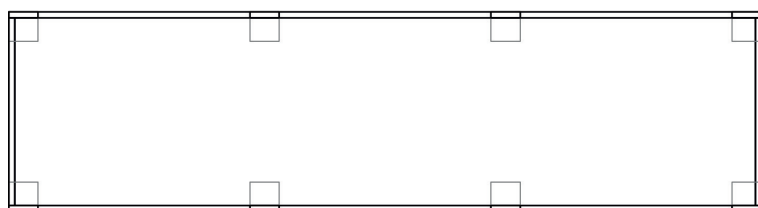

610

Panel length + 10mm

Pallet made of wooden boards, adapted to the dimensions of the panels.
55 pieces per pallet for panel thickness of 20mm

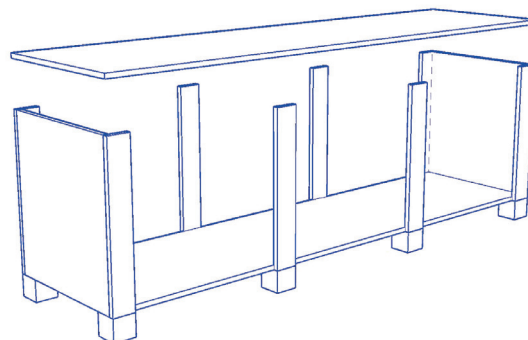

Additional information

Information and data contained in this technical sheet are meant to ensure the correct utilization and suitability of the product and are based on our knowledge and experience. Utilizers are not exempted from their responsibility of testing the suitability of the product prior to its installation. Any kind of utilization which is not included in the present sheet will require prior advice and will happen at own risk in case of lack of approval. This concerns especially any possible combined utilization with other products.

Our quality conditions and technical data sheets are updated and improved a continuous way. Therefore this sheet might no longer be valid at the time of future orders. We would like to point out that it is your duty to download the updated document from the customer portal (login via the website www.pedross.com) before each order.